

# CAMSO HUB & BOLT KITS

P/N 7019-00-0001 to 7019-00-0006

Application: CAMSO ATV / UTV TRACK SYSTEMS



Please keep this instruction sheet for future reference or parts ordering information.

## 4-Hub Kits Contents:

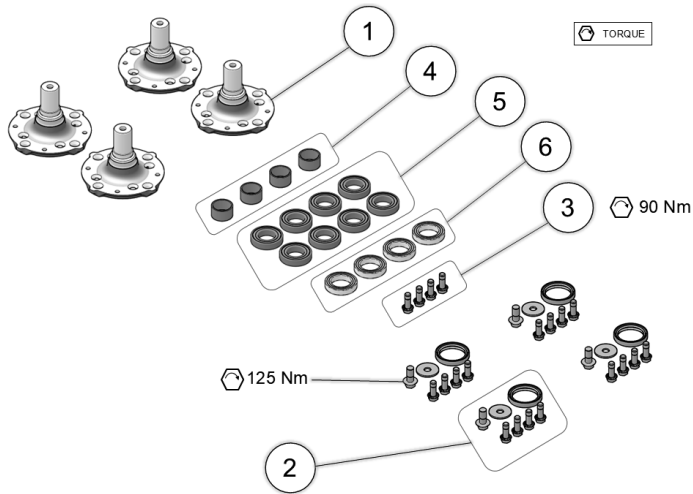

## Single Hub Kit Contents:

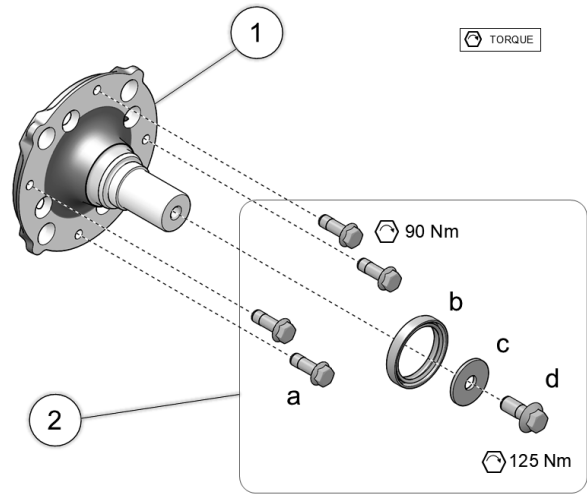

| Ref                 | Part description                         | Qty |
|---------------------|--|-----|
| <b>7019-00-0001</b> |  |     |
| 1a                  | 5-bolt pattern hub                       | 4   |
| 2                   | Hub assembly bolt kit                    | 4   |
| 3                   | HFSCS, M10-1.5X30,10.9, ZP, TL, DIN 6921 | 4   |
| <b>7019-00-0002</b> |  |     |
| 1b                  | Multi model hub                          | 4   |
| 2                   | Hub assembly bolt kit                    | 4   |
| <b>7019-00-0003</b> |  |     |
| 1c                  | 137mm - Adapted hub model                | 4   |
| 2                   | Hub assembly bolt kit                    | 4   |
| <b>7019-00-0004</b> |  |     |
| 1d                  | Polaris multi hub                        | 4   |
| 2                   | Hub assembly bolt kit                    | 4   |
| <b>7019-00-0006</b> |  |     |
| 1e                  | Hub UTV HD, Assy                         | 4   |
| 2                   | Hub assembly bolt kit                    | 4   |
| 4                   | UTV internal spacer                      | 4   |
| 5                   | Standard Bearing                         | 8   |
| 6                   | Bearing 6908 - PEER                      | 4   |

| Ref                 | Part description                              | Qty  |
|---------------------|---|------|
| <b>7019-00-0005</b> |   |      |
| 1e                  | Hub UTV HD, Assy                              | 1    |
| 2                   | Hub assembly bolt kit                         | 1    |
|                     | (a) HFSCS, M10-1.5X30,10.9, ZP, TL, DIN 6921  | (4x) |
|                     | (b) Double lips Shaft Seal                    | (1x) |
|                     | (c) Washer - W,1.625,0.515,11ga.              | (1x) |
|                     | (d) HFSCS, M12-1.75X30,10.9, ZP, TL, DIN 6921 | (1x) |

**\*\* Applies to 7019-00-0001 to 7019-00-0005 \*\***  
**(See p. 3 for kit # 7019-00-0006)**

## 1- Removal of existing parts

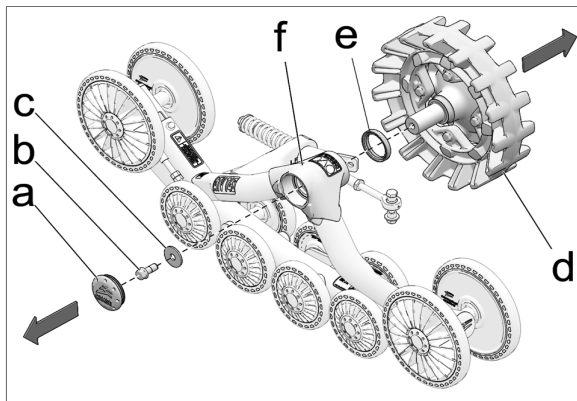

**1.1** Remove tracks from the Track Systems.

**1.2** Remove caps (a), hub bolts (b), and washers (c). Remove original hub and sprocket assemblies (d) from frames (f) and disassemble them. Remove hub seals (e). Discard hub seals, bolts and washers.

## 2- Installation of new parts

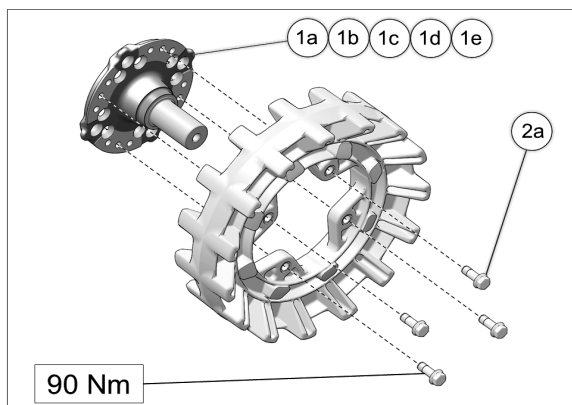

**2.1** Assemble new hubs (1) and existing sprockets using the new M10x30 mm flanged-head bolts (2a) [and (3) for 5-bolt pattern hubs], provided in the installation kit. Tighten to 90 Nm [66 ft-lbs] of torque.

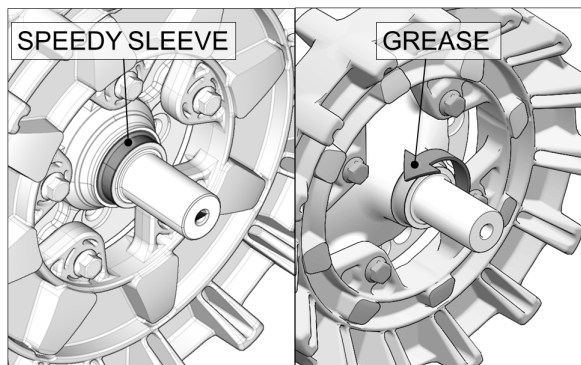

**2.2** Grease Speedy Sleeve on hubs before installing assemblies back in frames. Refer to the "Lubrication" section of the *User Manual*.

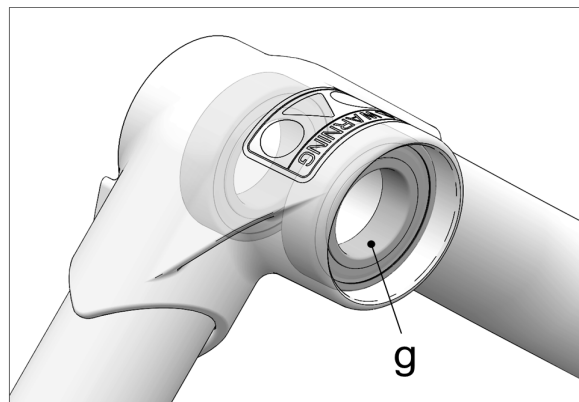

**2.4** Inspect bearings (g) before re-installing hub-sprocket assemblies. Replace as needed.

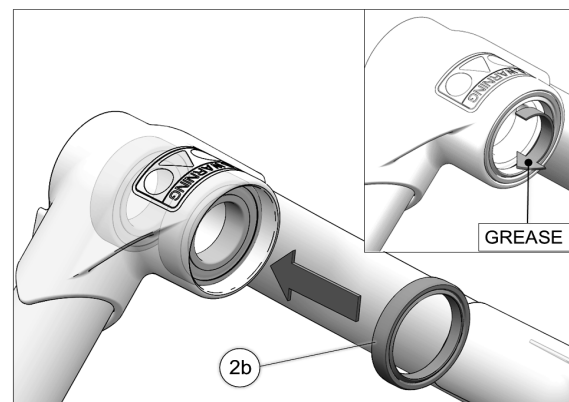

**2.5** Install new hub seals (2b).

**2.6** Grease hub seals. Refer to the "Lubrication" section of the *User Manual*.

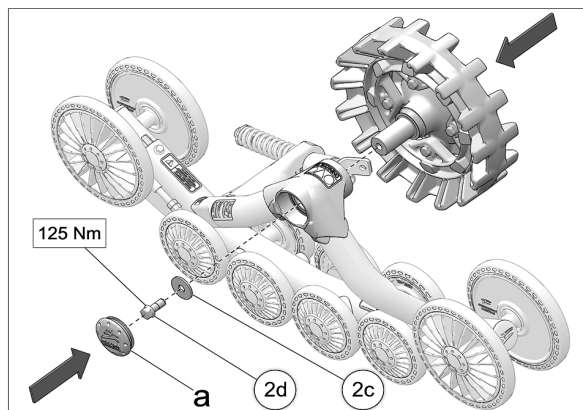

**2.7** Re-install new hub-sprocket assemblies in frames using new M12 hub bolts (2d) with new washers (2c). Tighten to 125 Nm [92 ft-lbs] of torque. Put hub caps (a) back on.

**NOTE:** Deformation of washer is normal and expected when tightening hub bolt.

**2.7** Re-install tracks on the Systems.

Modifications to the Systems are now complete. To finalize installation and adjustment of the System, see the *Installation Guidelines* specific to your vehicle.