

ATV WHEEL HOLDER KIT

P/N 1016-00-9999



Application: ATV TRACK SYSTEM

Kit Contents:

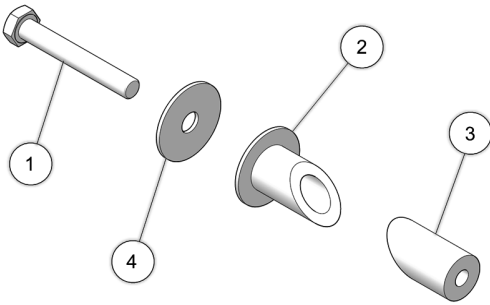

Ref	Part Description	Qty
1	Bolt - HCS, M8-1.25X55, 8.8, ZP, DIN931	1
2	Wheel anchoring base	1
3	Wheel anchoring taper	1
4	Washer - FW, 0.340x1.25x0.062, ZP	1

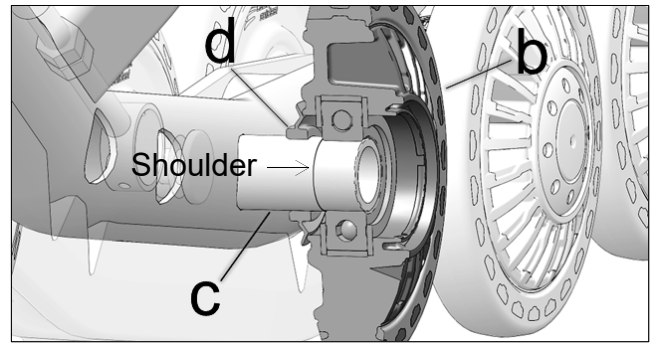

2.2 Make sure wheel (b) is seated against tube (c) shoulder, and greased seal (d) makes contact with back of wheel.

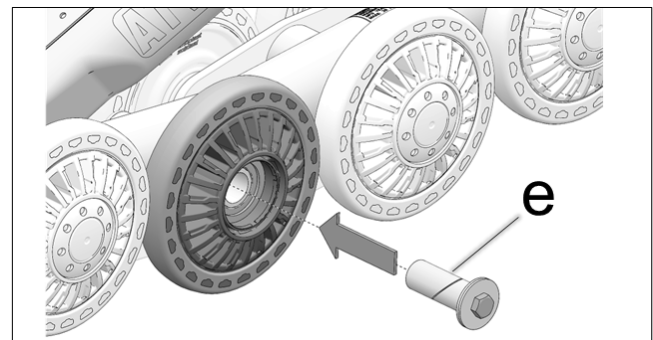

2.3 Insert assembled wheel holder kit (e) in hollow wheel shaft. Make sure holder kit is well seated against the wheel.

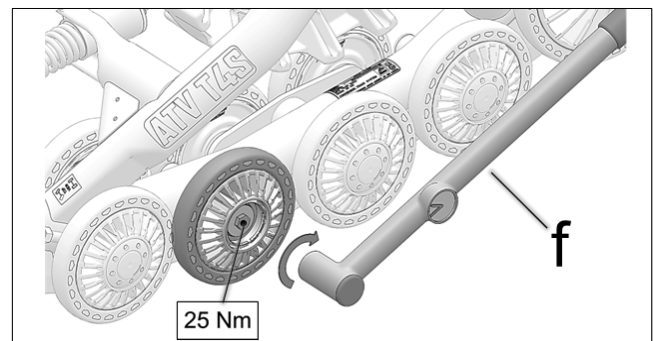

2.4 Using a torque wrench (f), tighten bolt (1) to 25 Nm of torque.

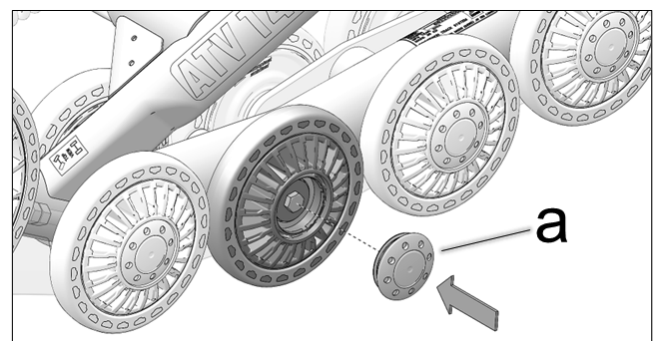

2.5 Re-install wheel cap (a).

1- Removal of existing parts

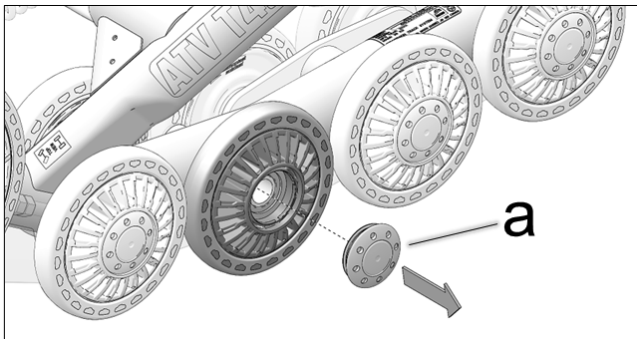

1.1 Pressed-on wheel only: Remove cap (a)

2- Installation of new parts

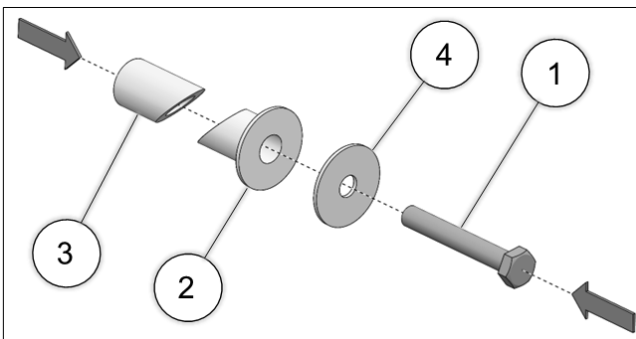

2.1 Assemble wheel holder kit: bolt (1), washer (2), anchoring base (3), and anchoring taper (4). Hand-tighten bolt at this step.

ENSEMBLE DE RETENUE DE ROUE ATV

N/P 1016-00-9999



Application : SYSTÈME DE TRACTION ATV

L'ensemble contient:

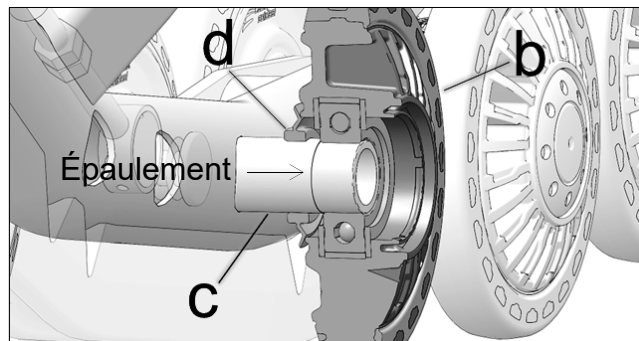
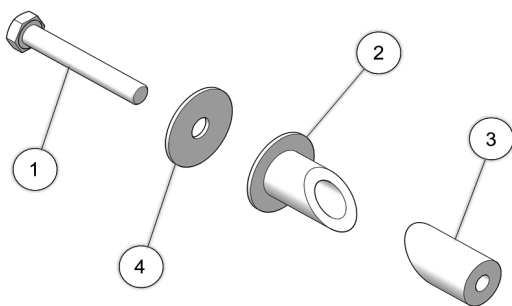

2.2 S'assurer que la roue (b) est bien appuyée sur l'épaulement du tube (c), que l'arrière de la roue contacte le joint d'étanchéité (d) graissé.

Réf	Description	Qté
1	Boulon - HCS, M8-1.25X55, 8.8, ZP, DIN931	1
2	Base ancrage de roue	1
3	Cône ancrage de roue	1
4	Rondelle - FW, 0.340x1.25x0.062, ZP	1

1- Démontage des pièces en place

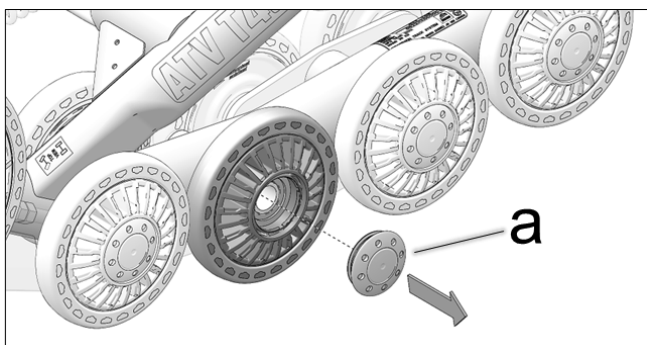

1.1 Roue pressée seulement. Retirer le capuchon (a) .

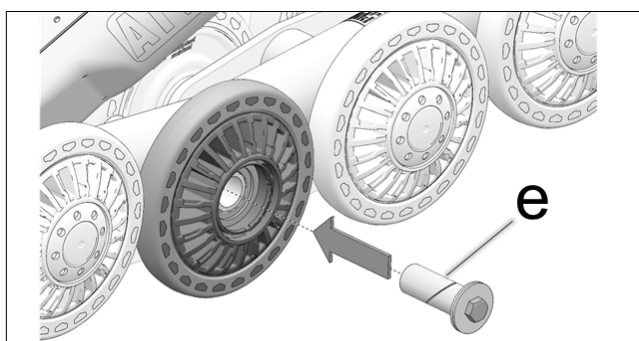

2.3 Insérer l'ensemble de retenue assemblé (e) dans le tube du cadre. S'assurer que l'ensemble de retenue est bien assis contre la roue.

2- Installation des nouvelles pièces

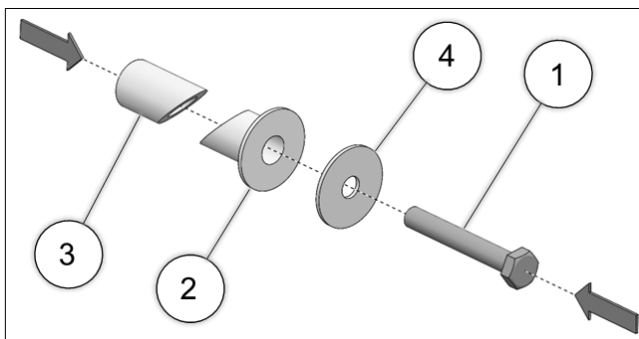

2.1 Assembler les pièces de l'ensemble de retenue: boulon (1), rondelle (4), base (2) et cône (3) d'ancrage. Serrer à la main temporairement.

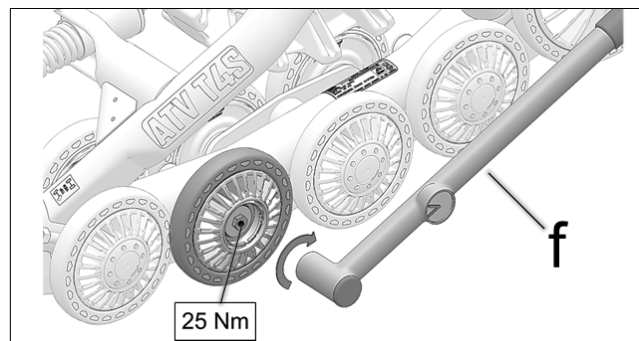

2.4 Serrer le boulon (1) à **25 Nm** en utilisant une clé dynamométrique (f).

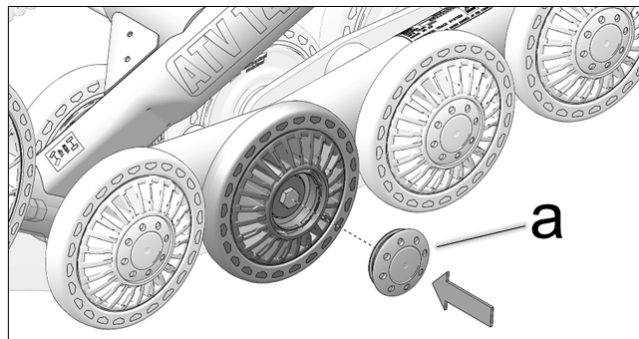

2.5 Réinstaller le capuchon de roue (a).